



# GALAXY ENTERPRISES

MANUFACTURE OF - ALL TYPE INDUSTRIAL LED LIGHTS

## COMPANY PROFILE

In 2013-2014 we stepped in service in Industrial sector regarding Lighting, Industrial Energy Saving Products. In 2015-2016 **M/s. Galaxy Enterprises** emerged which is growing immensely both way quantitatively and qualitatively in manufacturing of LED Lighting equipment under brand name '**3R LIGHT**', we have establishing ourselves as a market leading manufacturer of luminaries through our Innovative products.

Since then we have risen amongst the ranks of lighting experts to become one of the fastest growing and successful lighting companies in India.

In order to implement the right lighting solutions for our clients, our team of experts relies on a number of proprietary tools and approaches '**3R LIGHT**' is a proven innovator in the fields of design, technology and environmental responsibility.

The tools based on our extensive experience, high-quality products and the most modern technologies, empower '**3R LIGHT**' to deliver lighting solutions for all types Industrial lighting applications.

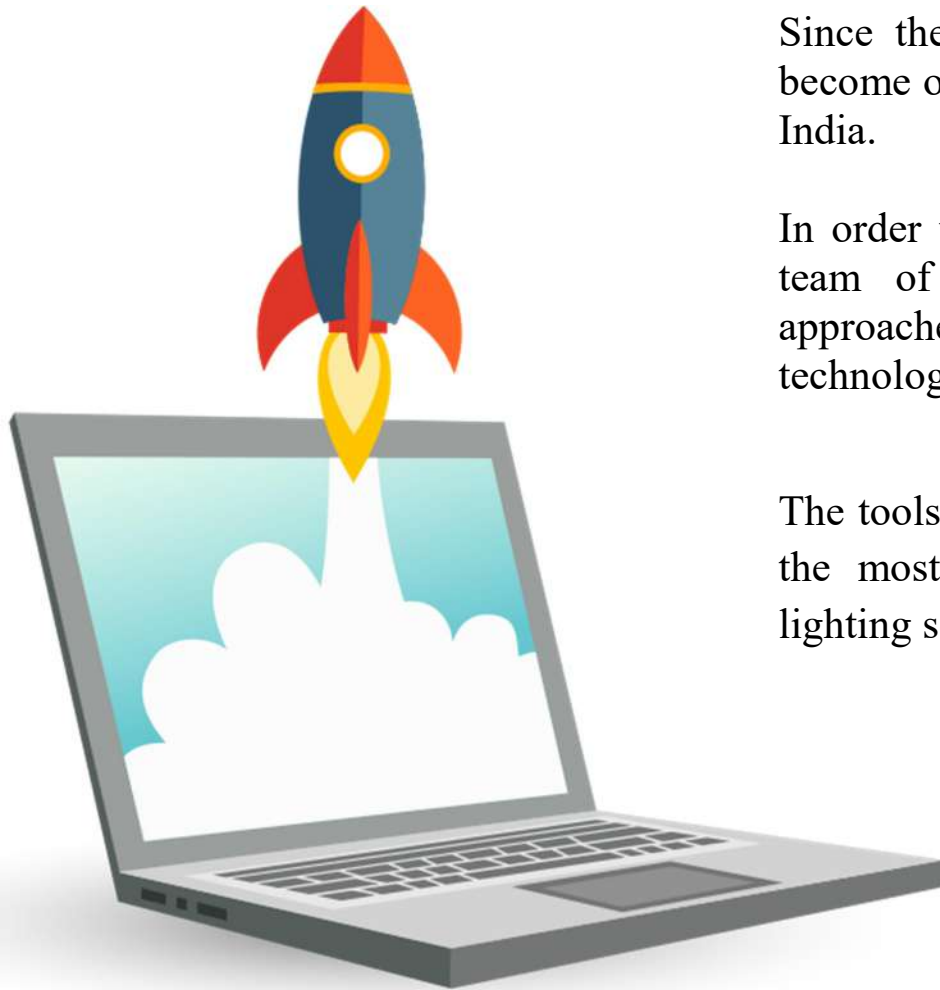

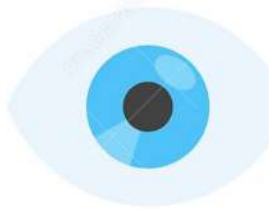

## VISION

- ❖ Leveraging Science to deliver new innovations.
- ❖ Enhancing values to our customers.
- ❖ Developing the new innovative thermal management in lighting systems.
- ❖ Long term relations with best pre post sales services.
- ❖ High quality standards and minimizing the impact on the environment



## MISSION

Save Planet through energy saving concept by providing energy efficient lighting innovative products and service solutions to customers with cost saving without compromising illumination quality.



## VALUES

- ❖ Integrity
- ❖ Excellence
- ❖ Innovation
- ❖ Flexibility
- ❖ Professionalism
- ❖ Cooperation
- ❖ Credibility
- ❖ Customer Satisfaction



**Mr. Ravindra Ajabe**

**Director (Operations, Technical, Sales & Marketing)**

Mr. Ravi Ajabe is the company founder members of Galaxy Group. In 2016 he has established Galaxy Enterprises with his colleagues. With his enthusiastic hard work and efforts Galaxy Group grown rapidly and achieving new height of success day by day. He established strategic mutually beneficial partnerships and relationships with user's vendors and service providers. Oversee, review, and adhere to the budgets for each business department. Analyze the financial climate and market. Adept at creating strategic alliances with organization leaders to effectively align with and support key business initiatives. Also he developed new marketing strategies to quickly capitalize on trends. Guide the sales team and technical team with advice and support.



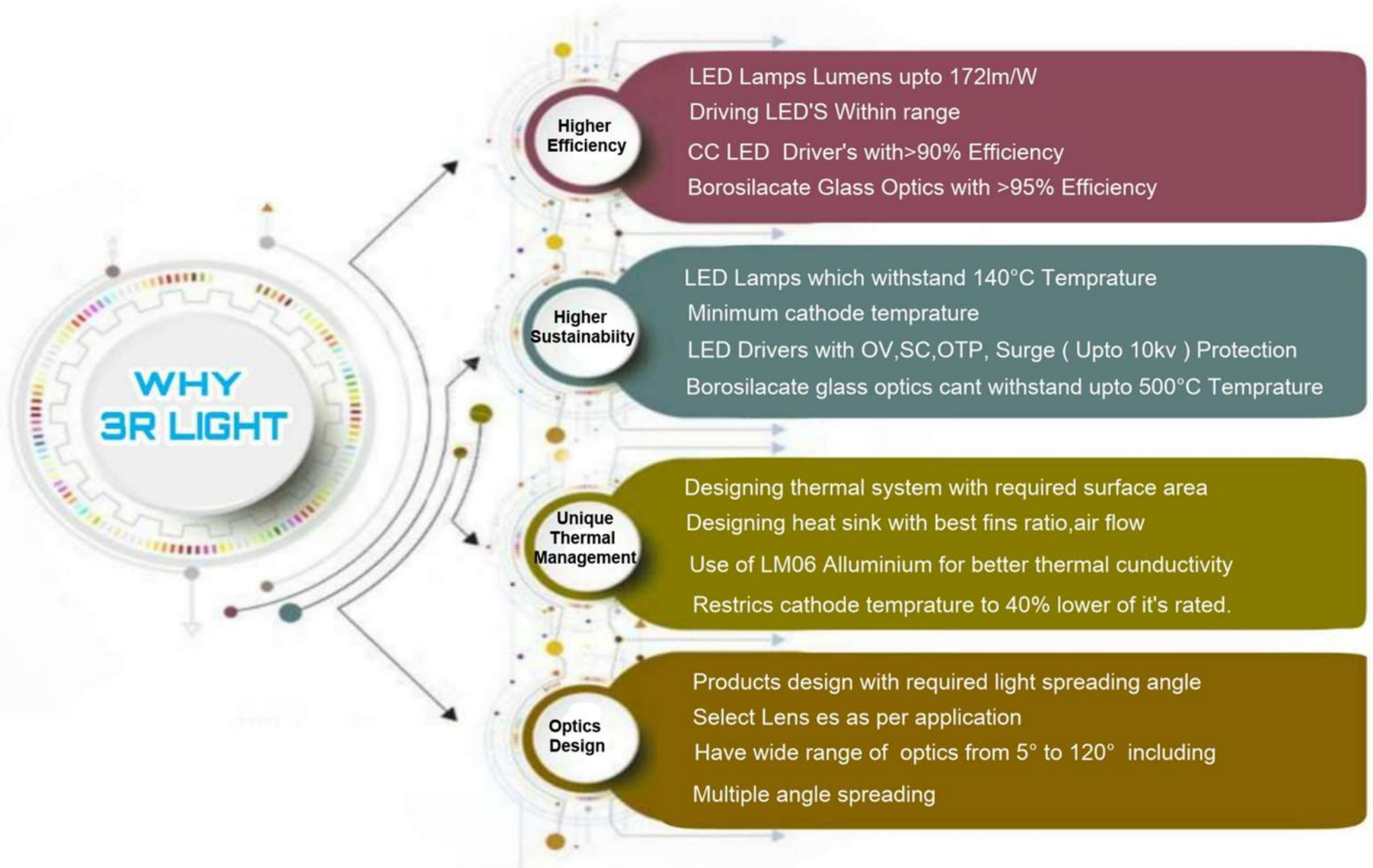

## PRODUCTION

We have integrated the production planning and control system for efficient, effective and economical Operation in organization. We have 2 assembly lines in 1200 Sq. Ft. Area with ESD Flooring and ESD Tables which reduces electrostatic discharge preventing interference and damage to electronic equipment and Both Lines balancing problem consists of assigning tasks to an ordered sequence of stations such that the precedence relations among the tasks are satisfied and some performance measure is optimized. 2 shifts are working to increase the output and achieve our goal.

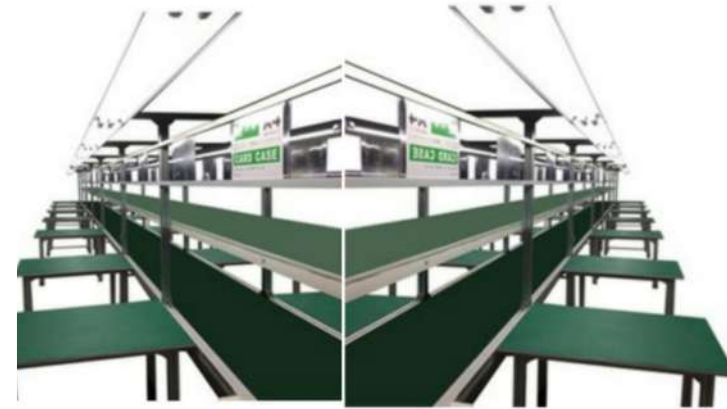

3R LIGHT Products should contribute demonstrably to an increased quality of life while conserving the scarce resources of our environment. 3R LIGHT products convince with easy specification and application, outstanding performance in the application, easy installation, maintenance and resource-friendly disposal at end of life. 3R LIGHT products contribute to saving energy and scarce resources through high efficiency and long service lives.



# QUALITY



Quality control process we ensure that product quality is maintained or improved and Manufacturing Errors are reduced or eliminated. Our Goal is to learn continuously so that quality would be better each Time and to avoid making errors by proper planning and execution with correct review process. All Components and final products thoroughly tested using precision equipment in line with stringent ISO9001: 2015 technical standards.

## Testing Facilities:





To achieve High quality means high accuracy, compliance with applicable standards products and high customer satisfaction we are using following facilities: Power analyzer, High Voltage (HV) Meter, Variable Transformer, Thermal Imager, Thermocouple, Constant DC Supply, 3 KV AC Supply

**Facility to Vendor end:-**

Surge Generator (15KV), Insulation Resistance (IR) Meter, , Load Analyzer, Temp Indicator and Thermal Chamber, IP testing Facility, Photometric-Spectroradiometer Set (SPHERE 2.0), 3 KV AC Supply.





# LIGHTING DESIGN SUPPORT:

We provide all type of illumination design for virtual lighting results using illumination design software's like DiALux and CGLux that actually helps to select appropriate luminaires for best results.

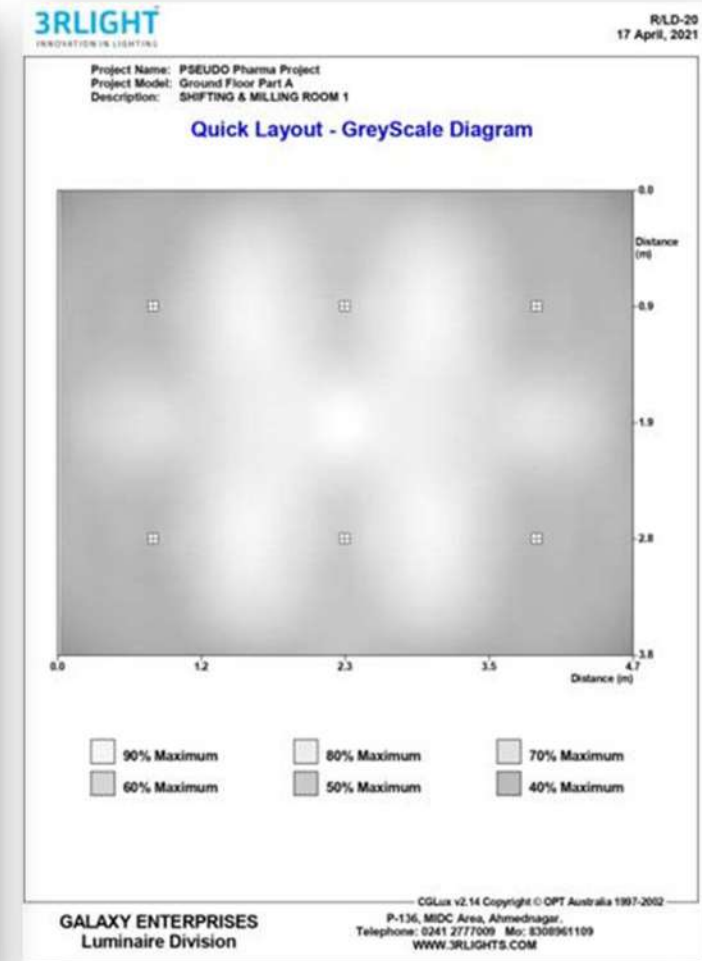
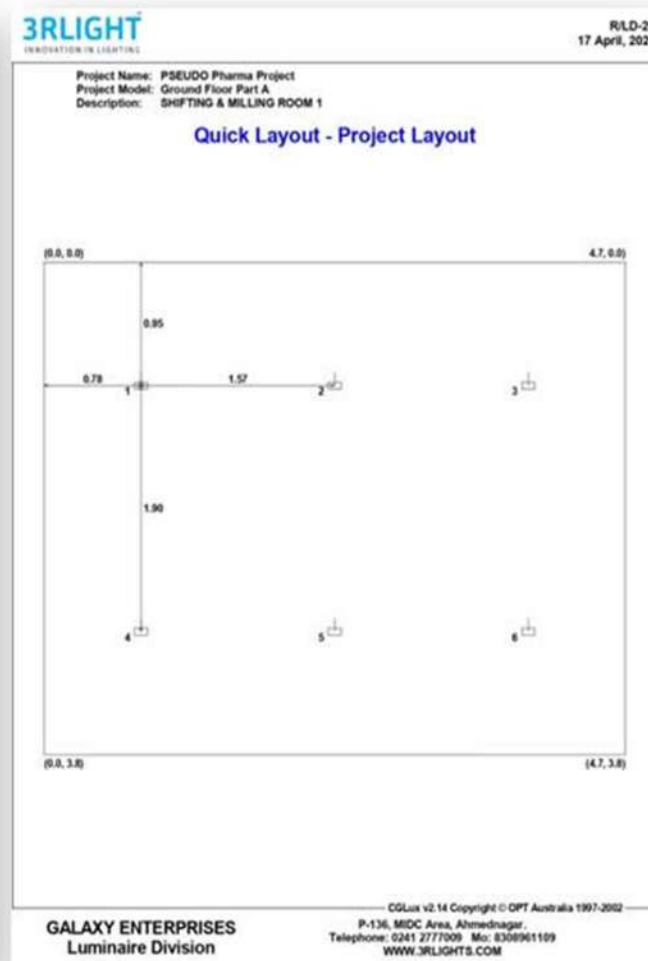
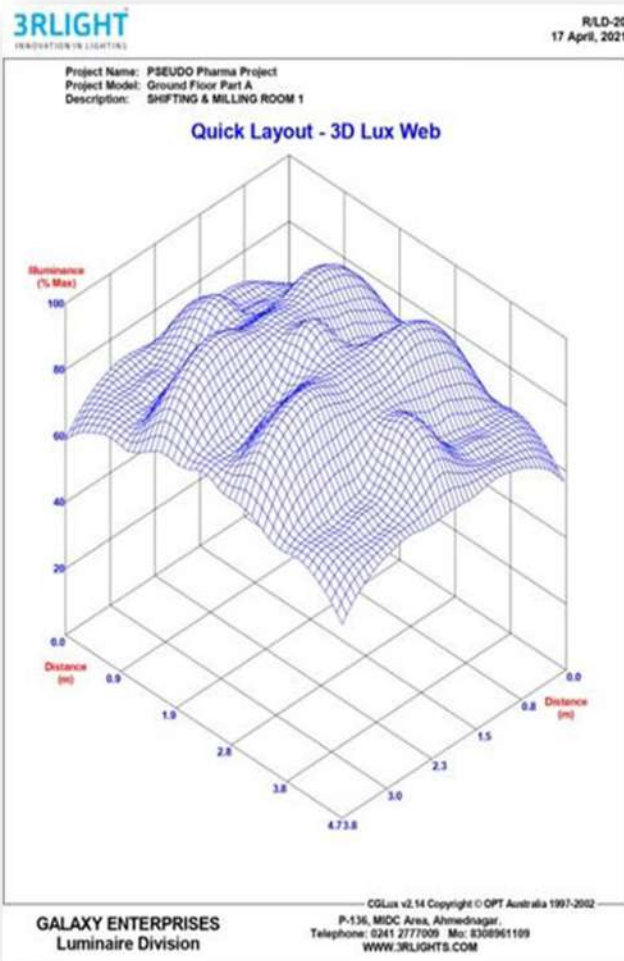



## STRATEGIC COLLABORATION:

To expand and growth of Galaxy Enterprises we had been working to develop new business in forward and backward integration of LED luminaries manufacturing. We have made certain strategic JV's/Collaborations with below mentioned companies in betterment of Galaxy Enterprises business.

### Isha Industrial Solutions:-



ISHA Industrial Solutions

A company having 5 years of experience in Solar Street Light .They were basically in Industrial Solutions Provider. (Timer, all in one solar lighting, emergency lighting, Exit sign systems, AC/DC Machine lamp, Electrical & Electronic Meters, Eco Lighting)

We had done JV in this company

So we are having our own control in Solar lighting as well as Industrial Solutions Providing

### PRODUCTS :-



## GLOBAL PARTNERS:

INVENTRONICS

**OSRAM**  
LED

**MW**  
MEAN WELL

**CITIZEN**  
Micro HumanTech  
MADE IN JAPAN

**MOSO**<sup>®</sup>

bridgelux<sup>®</sup>

**FULHAM**  
DRIVER

**DOW CORNING**

b,ag, India

  
**Pidilite**

**intelux**  
Redefine.  
DRIVER

  
**TIMTRONICS**  
THERMAL INTERFACE MATERIALS











# EVENTS:



## PROJECTS:





## PROJECTS :



## HAPPY CLIENTS:

**MACCAFERRI**

**eternis**

**FEV**  
India Pvt. Ltd.

**AVIANS**

**SIPRA**  
Quality Advantages

**xproindia**

**JYOTI**  
Sealing & Press Components Pvt. Ltd.

**iAi**

**TI**  
INDIA

**Aarti Drugs Ltd**

**posco**

**classic**

**MASCHIO**

**3A**  
COMPOSITES

**Varroc**  
ROTOR PUMP

**SM**  
S.M.AUTO

**brembo**

**TRANSTER**  
The heat transfer people

**TALCOTE INDIA**

**Expo**  
EXPO GAS CONTAINERS LTD.

**MAGNA**  
COSMA INTERNATIONAL

**Lloyds Steel**

**PADMAVATI**  
PULP AND PAPER MILLS

**SI Group**

**SOLIDUS**

**JAPFA**

**AARTI INDUSTRIES LIMITED**

**SWARAJ**  
INDIA INDUSTRIES LTD.

**Approcopp**  
Engineering Pvt. Ltd.

**BAJAJ POWER**  
EQUIPMENTS PVT. LTD.

**ANTOLIN**  
INDIA

**LINAMAR**

**G**

**laxmi**

**Kaygaon**  
Paper Mills Ltd

**FOSECO**

**NRB BEARINGS**  
THE ORIGINAL

**tirumalla**  
Private Oil & Foods  
Part of Tirumala Group

**Align Components Pvt. Ltd.**

**ORICON**  
ENTERPRISES LTD.

**TECHNOCRAFT**  
INDUSTRIES INDIA LTD.

**Natra pulp & paper mills Ltd.**

**SKH**

**WOCKHARDT**

**MEIPL**  
FOR PLASTIC SPEED

**Schneider**  
Electric

**SLN Pharmachem**

**RATHI STEEL**

## HAPPY CLIENTS:







## **GALAXYENTERPRISES**

Plot No. : P-136, Behind Kamda Machine Tools,  
MIDC, Ahmednagar – 414111.

Contact No. : 8308961109 / 9922973109 / 8308831109 / 8308841109. Tel. No: 0241 – 2777009.

E-Mail ID : [Info@3rlight.com](mailto:Info@3rlight.com) / [Marketing@3rlight.com](mailto:Marketing@3rlight.com) / [Galaxy.ent3316@gmail.com](mailto:Galaxy.ent3316@gmail.com)      [WWW.3RLIGHTS.COM](http://WWW.3RLIGHTS.COM)